

CHILD INFORMATION
(KEEP WITH CAR SEAT AT ALL TIMES IN CASE OF EMERGENCY)
NAME:

.....

DATE OF BIRTH (DD/MM/YYYY):

.....

ADDRESS:

.....
.....
.....

ALLERGIES/MEDICAL CONDITIONS:

.....
.....
.....

EMERGENCY CONTACT 1:
NAME:
PHONE NUMBER:
EMERGENCY CONTACT 2:
NAME:
PHONE NUMBER:

www.cozynsafe.com

Cozy N Safe
Oxford Street, Wolverhampton, West Midlands, WV14 7DP, UK
Tel: +44 (0) 1902 494905 | Email: enq@cozynsafe.com



COMET i-Size

EST-316

Instruction Manual

Contents

- 1. Critical information – Please read immediately..... 2-4
- 2. Install location.....5
- 3. Parts and interior equipment.....6
- 4. Technical Pparameter..... 7
- 5. Product information..... 8
- 6. Using the buckle.....8
- 7. Adjust the headrest.....9
- 8. Adjust safety belt length.....10
- 9. Romoving sleeping pad.....10
- 10. Adjust the rotation of the seat.....11
- 11. Adjust the angle of the child safety car seat.....12
- 12. Adjust the length of support leg.....13
- 13. How to use the isofix guide.....14
- 14. How to use the isofix14
- 15. Installation(40-105cm).....15
- 16. Installation(76-105cm).....16
- 17. Installation(100-150cm).....17-19
- 18. Maintenance and cleaning.....20
- 19. List of approved cars.....21-24

Notice

If in doubt, consult either the Enhanced Child Restraint System manufacturer or the retailer.

This is an i-Size Enhanced Child Restraint System. It is approved according to UN Regulation No.129/03, for use in i-Size compatible vehicle seating positions as indicated by vehicle manufacturers in the vehicle user's manual.

NOTICE- NOT TO USE REARWARD FACING ECRS (ECRS= Enhanced Child Restraint System) IN SEATING POSITIONS WHERE THERE IS AN ACTIVE FRONTAL AIRBAG INSTALLED.

IMPORTANT-DO NOT USE FORWARD FACING BEFORE THE CHILD'S AGE EXCEEDS 15 MONTHS (Refer to instructions).

Notice : Regarding i-Size category Enhanced Child Restraint Systems (40-150cm)

1. Critical information – Please read immediately.

To ensure the safety of your child, it is imperative that you carefully review and comprehend these instructions before utilizing the product. Additionally, we strongly advise you to retain this manual for future reference. Neglecting to adhere to the guidelines outlined in this document may lead to severe harm or injury to your child.

1. The utilization of the harness is limited to children within the height range of 40-105cm when using this child safety seat.
2. You may store this instruction manual within the designated compartment of the child seat throughout its entire lifespan
3. Please refrain from using this child safety seat in a home setting. It has been exclusively designed for use in vehicles and should not be utilized outside of this intended purpose.
4. It is imperative that you never leave your child unattended in the child restraint system, even for a brief period.
5. The child safety seat should be changed when it has been subject to violent stresses in an accident.

6. For the safety of all occupants, it is vital to securely fasten this child restraint in the vehicle, even when it is not being used. In the event of a collision or abrupt stop, an unsecured child safety seat can pose a risk of injury to other individuals in the vehicle.

7. Always make sure that any straps holding the seat restraint to the vehicle shall be tight, any straps restraining the child should be adjusted to the child's body, and check that the straps shall not be twisted.

8. **IMPORTANT:** It is crucial to ensure that any lap straps are worn in a low position, firmly engaging the pelvis.

9. Please refrain from utilizing any load-bearing contact points that are not explicitly outlined in the provided instructions or marked on the child restraint. In case of uncertainty, we strongly advise reaching out to the manufacturer of the child restraint for further guidance.

10. Ensure that all luggage or other objects which have the potential to cause injury in the event of a collision are securely fastened or properly secured.

11. During the routine use of the vehicle, it is crucial to position and install the rigid items and plastic components of a child restraint in a manner that prevents them from getting trapped by a movable seat or vehicle door.

12. In order to mitigate the risk of falls, it is imperative to always secure your child by fastening them appropriately.

13. Making any alterations or additions to the device without the approval of the competent authority is perilous. Furthermore, failing to closely adhere to the installation instructions provided by the child restraint manufacturer can also pose a significant risk.

14. This child safety seat is specifically designed for children ranging from 40 to 150cm in height. It is crucial to never exceed the recommended capacity of the child safety seat by placing more than one child or additional loads on it.

15. It is imperative to always utilize the child restraint with its cover and never use it without it.

16. To maintain the intended performance of the restraint, it is crucial to avoid replacing the seat cover with any other alternative not recommended by the manufacturer. The cover is an integral component that contributes to the overall effectiveness of the restraint system.

17. Prior to adjusting any movable or adjustable parts of your child safety seat, it is essential to remove your baby from the seat.

18. If the child safety seat does not have a textile cover, it is important to keep it away from direct sunlight to prevent excessive heat that could potentially discomfort or harm the child's skin.

19. It is strongly advised to refrain from using second-hand products, as it is impossible to ascertain their complete history or what may have occurred to them.

20. Attention: It is crucial to strictly adhere to the configurations and setups illustrated in the provided instructions and avoid using any other unlisted configurations.

21. Important Notice: Prior to using the ISOFIX child restraint system, it is essential to thoroughly read the manual provided by the automobile manufacturer for specific instructions regarding the ISOFIX fix points.

22. The support leg must be fully in contact with the ground of the vehicle.

2. Install location

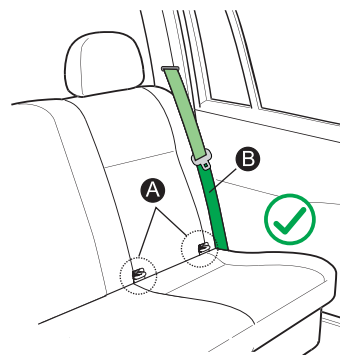

- A ISOFIX Attachments
- B 3-point Safety Belt

When using as i-Size

The ECRS system is designed for vehicles that meet the R16 requirements. It can only be used after installing ISOFIX in the vehicle.

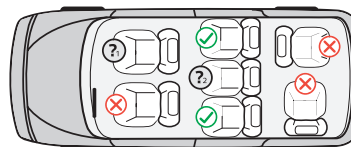

- ✓ Installation in this position is allowed and feasible.
- ✗ Installation in this particular position is not feasible or permitted.
- ⊕ Installation of the seat in a location where the front airbag is active is strictly prohibited.
- ⊕ Installation in this location is only permissible when using ISOFIX attachments.

3. Parts and interior equipment

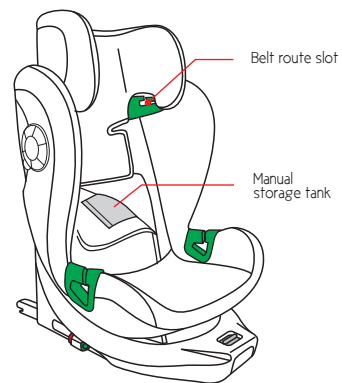
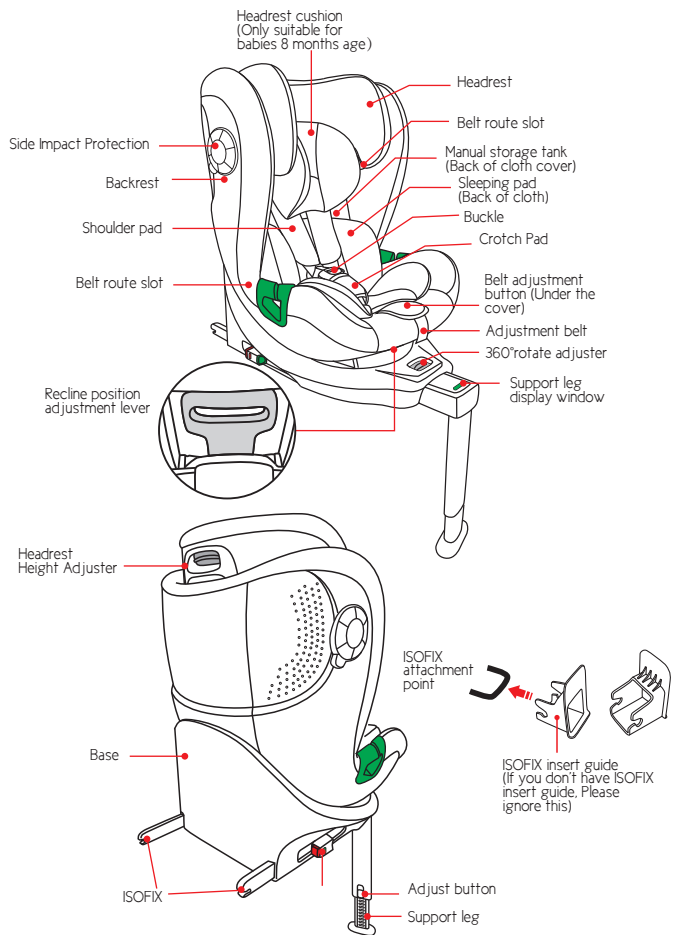

4. Technical Parameter

Length: 500mm
 Width: 438mm
 Height: 585-790mm

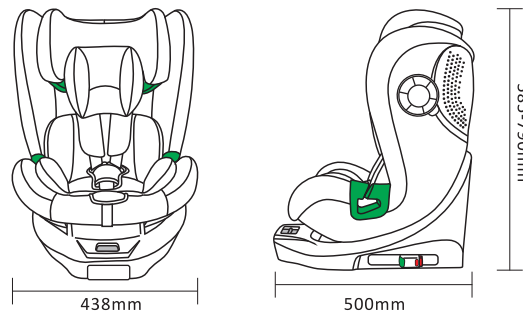

5. Product information

This product is a child restraint system with a 360-degree rotating feature. The following information will provide you with a better understanding of this product.

Tested and approved according to ECE R129/03			
	Body size	Installation method	Installation direction
I-size	40-105cm ≤ 18kg	Isofix+support leg	Rearward Facing
	76-105cm ≤ 18kg	Isofix+support leg	Forward facing
	15kg ≤ 100-150cm ≤ 36kg	Isofix+ 3-point safety belt	Forward facing
		3-point safety belt	Forward facing

6. Using the buckle

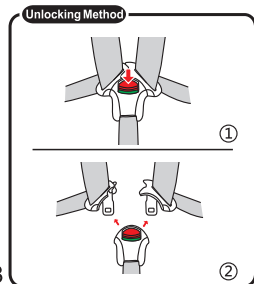
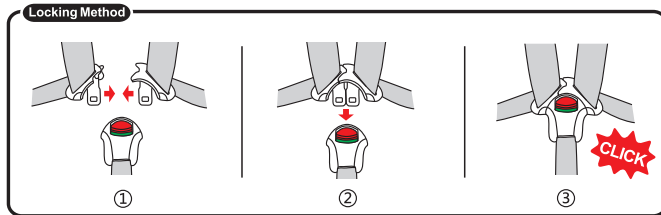

Locking Method:

Align the left and right buckle tongues into a single tongue and insert it into the buckle until you hear a distinct 'Click' sound.

Unlocking Method:

To release the buckle, press the red button downward, causing the two metal sections to pop up.

8

7. Adjust the headrest

The Headrest are adjusted as follows:

To make adjustments to the child seat, begin by loosening the shoulder straps to their maximum extent. Then, pull the headrest height adjuster and choose the appropriate height for the shoulder straps. Secure the straps in a position that fits your child by releasing the adjuster. Finally, pull the headrest to ensure it is properly locked into place after the adjustment.

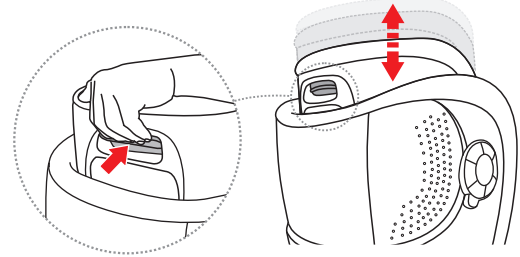

Lorem ipsum

ATTENTION!

Ensuring the headrest is properly adjusted is crucial for providing optimal protection to your child in the safety seat.

It is essential to adjust the headrest in a manner that aligns the shoulder straps with your child's shoulders.

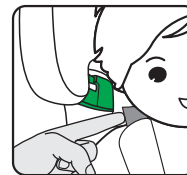
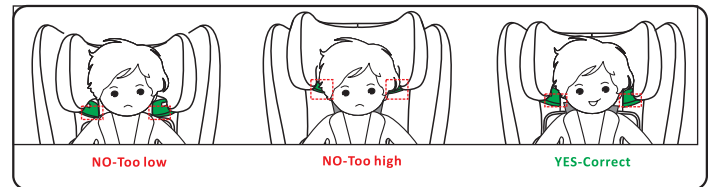

Adjust the headrest to the appropriate position where the distance between the child's shoulder and the bottom of the headrest allows for a one-finger gap.

9

8. Adjust safety belt length

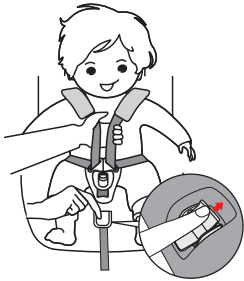

To loosen the shoulder harness, simultaneously press the adjuster button located beneath the cover and pull both shoulder straps forward.

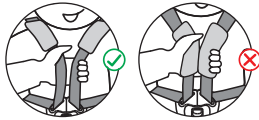

To tighten the shoulder harness, pull the adjuster strap until the harness is securely and completely tightened.



9. Removing New Born Insert



Once your child's height exceeds 60cm, it is necessary to remove the New Born Insert.

10. Adjust the rotation of the seat

Using your thumb, pull the rotation adjuster outwards. Set the switch to the unlock mode, and proceed to rotate the safety car seat to a 360° angle. (refer to picture a). **ACTION:** After each rotation, firmly push the rotation adjuster back into place to ensure that the seat is securely fixed.

(1)Rearward Direction:(40-105cm), must use rearward direction (see picture 1)

(2)Forward Direction: (76-150cm), must use forward direction (see picture 2)

WARNING: When the seat is rotated to a 90-degree angle, it is permissible to place the child in this position. However, it is important to note that this angle should not be used while driving. (see picture 3)

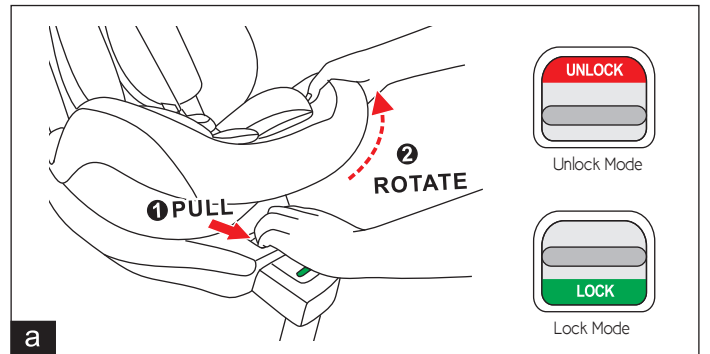
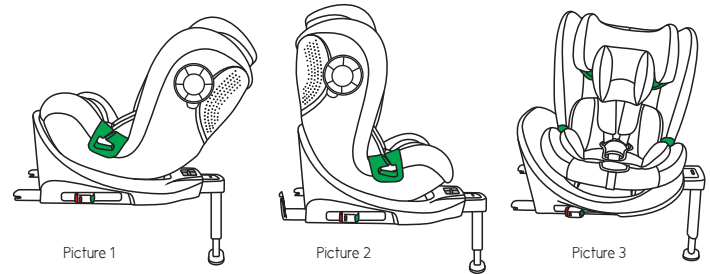

11. Adjust the angle of the child safety car seat

To adjust the seat, push the recline handle upward and pull the seat outward as shown in the picture. This allows for adjustment in 4 positions when using the seat in a forward-facing direction. However, when rotating the seat to the rearward direction, only the 4th gear can be used. Please note that the upright position is recommended for children between 100-150cm in height.

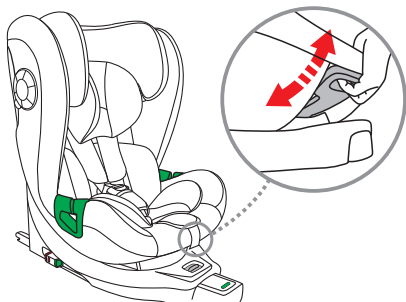

Installation of rearward facing	Installation of forward facing					Installation of forward facing
40-105cm, $\leq 18\text{kg}$	76-105cm, $\leq 18\text{kg}$					15kg \leq 100-150cm, $\leq 36\text{kg}$
Fourth Level (Lying level)	First Level	Second Level	Third Level	Fourth Level	First Level (Lying level)	
Note: Do not use forward facing before the child's age exceeds 15 months						

12. Adjust the length of support leg

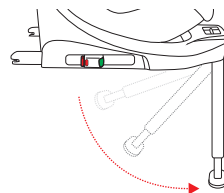

STEP 1: Pull out the support leg to the maximum angle.

STEP 2: Pull out display window completely

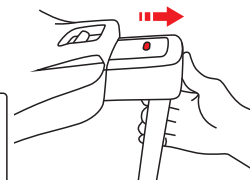
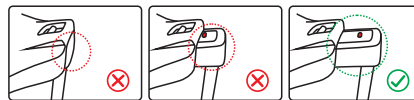

STEP 3: Press the adjust button of support leg, hold the support leg using the other hand and then adjust the length of support leg.

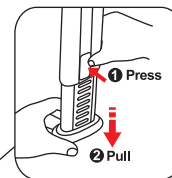
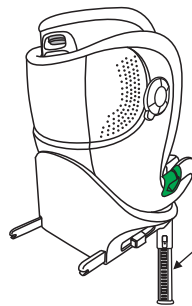

STEP 4: When support leg is in full contact with the ground of vehicle so that can release the adjust button. Pull the support leg to make sure it is locked.

Notice: After finishing the installation of support leg, display window turns into green color.

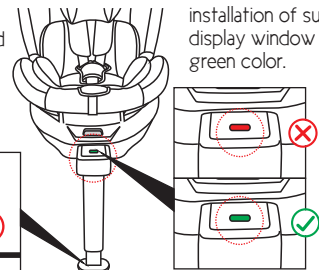
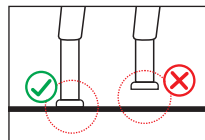

13. How to use the isofix guide

In order to lock the isofix connector to the steel point successfully, it can use isofix guide.

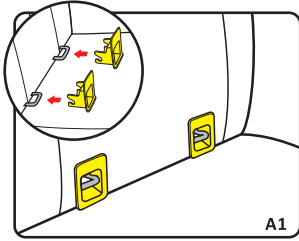

A1

Step 1 : Locate the ISOFIX connection points in your car and insert the ISOFIX guides to facilitate the installation process.

If you do not have an ISOFIX insert guide, you may disregard this step.

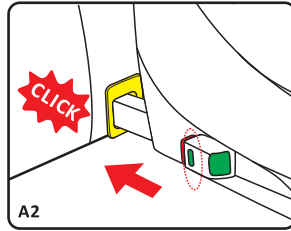

A2

Step 2 : Ensure that both ISOFIX connectors are firmly and securely attached to their respective ISOFIX anchor points.

14. How to use the isofix

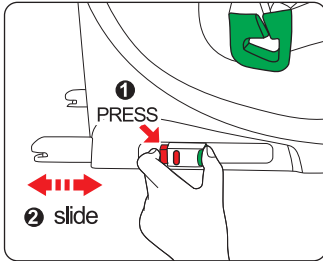

To retract or unlock the ISOFIX interface, press and hold the switch in place.

15. Installation (40-105CM)

Installed in Rearward facing position with ISOFIX and support leg (40-105cm)

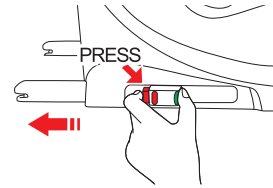

STEP 1: Set the seat tilt angle to the fourth Level position.

STEP 2: Press the ISOFIX button to release the two locking arms from the base bottom.

STEP 3 : Insert the locking arms into the ISOFIX attachment points until you hear an audible **CLICK**, signifying that they are fully engaged. Additionally, ensure that the buttons on both sides of the locking arms turn into a green safety color.

STEP 4 : Extend the support leg and adjust it to ensure full contact with the ground of the vehicle. Verify that the display window of the support leg turns into a green color.

STEP 5 : Place the child into the seat and securely fasten the harness. Pull the adjuster strap until the harness is fully tightened.

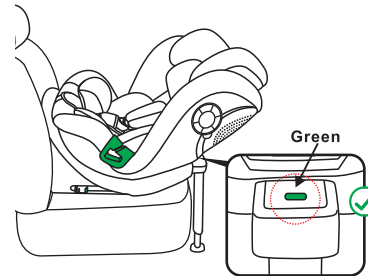
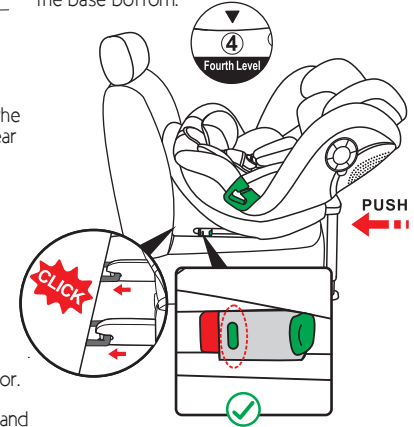

16. Installation (76-105CM)

Installed in forward facing position with ISOFIX and support leg (76-105cm)

IMPORTANT : Do not use forward facing before the child's age exceeds 15 months.

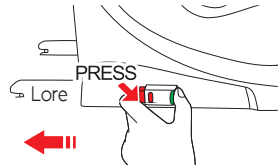

STEP 1: Press the ISOFIX button to release the two locking arms from the base bottom.

STEP 2: Insert the locking arms into the ISOFIX attachment points until you hear an audible **CLICK**, indicating they are fully engaged. Verify that the buttons on both sides of the locking arms turn into a green safety color.

STEP 3: Extend the support leg and adjust it to ensure full contact with the ground of the vehicle. Verify that the display window of the support leg turns into a green color.

STEP 4: Place the child into the seat and securely fasten the harness. Pull the adjuster strap until the harness is fully tightened.

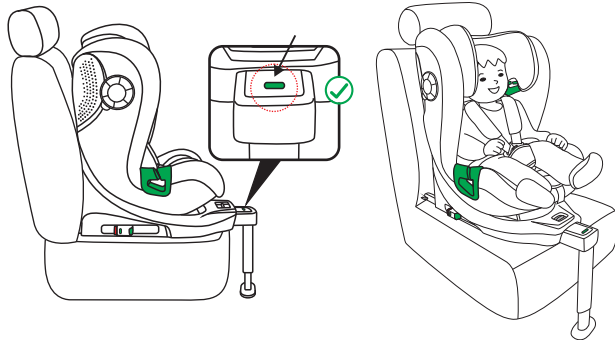
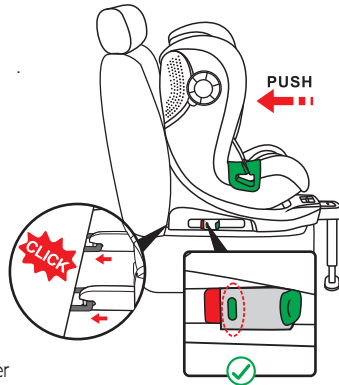

17. Installation (100-150CM)

17.1 Hide five-point safety belt system:

Step 1: Open the fabric cover of the backrest and thread the harness through the hole.
Step 2: Position the buckle in the booster, which is located under the cover.

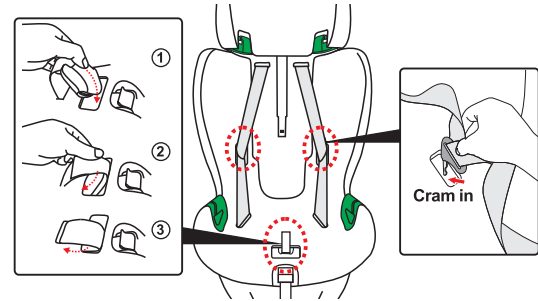

17.2 Hide support legs:

Press the adjust button of the support leg.

Retract the support leg.

Press the display panel button icon "PUSH" with your thumb.

Push the panel forward to hide it.

Fold the support leg in half for storage.

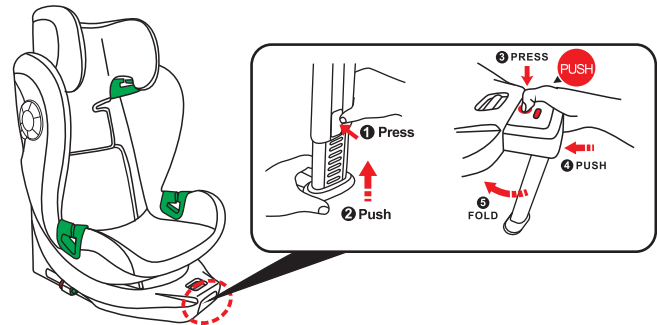

17.2 Install the baby car seat(100-150cm)

1. Using ISOFIX:

Connect the ISOFIX connectors to the anchorage points on the car seat.

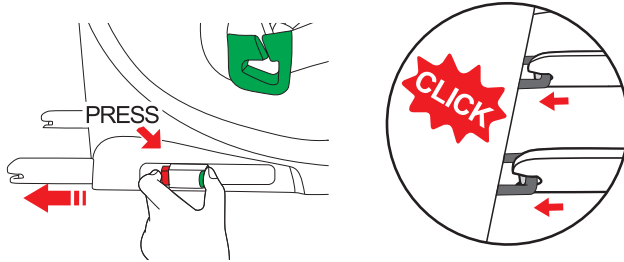

2. Not using ISOFIX:

Conceal the ISOFIX connectors in the booster. Position the seat against the car seat and use the 3-point car seat belt for installation.

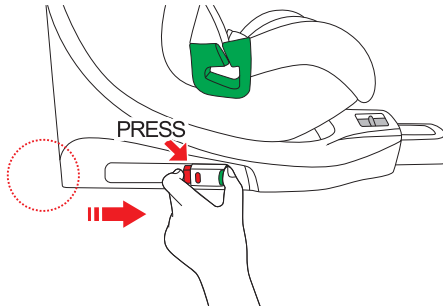

STEP 1: Ensure that the support leg is concealed and adjust the seat tilt angle to the first gear. Position the seat against the car seat.

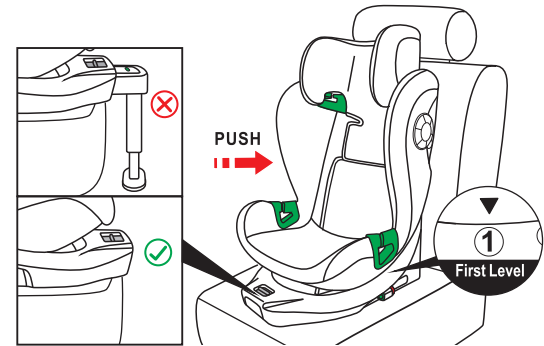

STEP 2: Place the child in the seat and secure them by following the path ①②③. Ensure that the seat belt is tightened adequately.

Important: It is crucial to emphasize that the lap straps should be worn low down, ensuring that the pelvis is securely engaged.

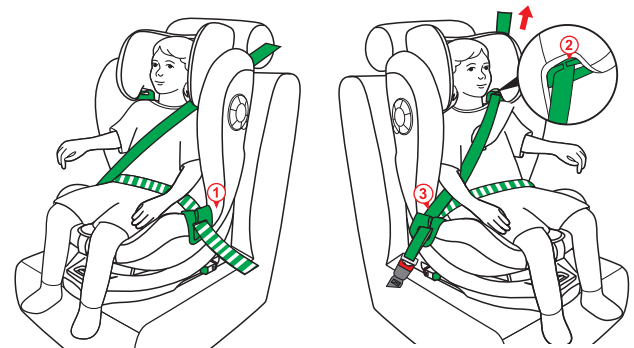

CARE AND MAINTENANCE

Regularly examine your child seat for signs of wear or damage. If any damaged parts are detected, replace the child seat immediately. Maintain cleanliness of the child seat by avoiding the use of lubricants on any parts. To extend the lifespan of your nursery product, ensure it is kept clean and protected from prolonged exposure to direct sunlight. For removable fabric covers and trims, clean them with warm water and a mild detergent. Allow them to dry completely, preferably away from direct sunlight.

CARE AND MAINTENANCE

To maintain the proper functioning of the harness buckle, it is important to keep it clean and free from any food, drink, or debris that may accumulate inside. You can wash the buckle in warm water until it is clean. Always ensure that you can hear an audible click when using the buckle to ensure it is working correctly.

CLEANING THE HARNESS AND SHELL

To clean the child safety seat, use a sponge with warm water and mild soap. Avoid using any other cleaning agents, as they may damage the seat or its components. Gently wipe the surfaces of the seat with the sponge to remove dirt or stains. After cleaning, allow the seat to air dry completely before using it again.

STORAGE

For proper storage of the child safety seat, choose a safe and dry location away from heat sources and direct sunlight. It is important to avoid placing heavy objects on top of the seat, as this can cause damage. By storing the seat in a secure and protected area, you can help maintain its integrity and prolong its lifespan.



Hand wash, water temperature below 30°C



Do not bleach



Dry clean any solvent except trichloroethylene



Do not tumble dry



Do not iron

The following vehicle list is only for reference. If your vehicle does not in the list, before using, please consult with the retailer or manufacturer.

This car seat is approved for stature height 40–150cm, but it could not fit all seating positions at a stature of 135cm.

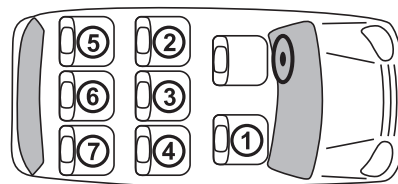

Saloon



No. of doors



Estate



No. of seat



Convertible



Before you purchase the vehicle, check that it is equipped with the appropriate anchorages



Hatchback



Year of manufacture



MPV











Maximum body height



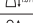
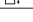

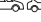
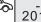
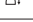
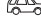



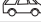





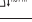

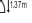

Coupe



















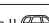
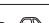
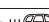

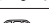

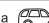
②④ Approved seats

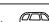

ALFA ROMEO *		
156 Sportwagon / Crosswagon Q4	1997 2007	②④
159 Sportwagon	2005 2011	 ②④
Giulietta 940	2010	 ②④
GT Sportcoupe 	2004 2010	 ②④
MiTo	2008	 ①②④
BMW *		
1(E87/E82/E81)  3+5	2005	②④
1(E82) 	2007	②④
1(E88) 	2008	①②④
3(E90) 	2005	②④
3(E92) 	2005	②④
3 	08/05	②④
5(F10) 	2010	②④
5(F11) Touring	2010	②④
5 GT	10/09	②④
7(E65) (Facelift 2005)	2001 2008	②④
7(F01)	2008	②④
Mini Club Man	2007	②④
Mini Countryman  4	2010	②④
Mini Countryman  5	2010	④
X1	10/09	②④
X5	2006	②④
X6	2008	 ②④
Z4  	2002	ISOFIX ①
DACIA *		
Duster	2010	②④
Lodgy	2012	②③④

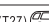
Logan 	2004	②④
Sandero	2008	②④
Sandero Stepway	2009	②④
Sandero Live 2	2012	②④
FORD *		
B-MAX	2012	②④
C-MAX	2011	②④
C-MAX	2003 2010	②④
Fiesta(MK7)  3+5	2008	 ②④
Fiesta	2012	 ②④
Focus	2011	②④
Focus   	2004 2010	 ②④
Focus Turnier 	2008 2010	②④
Kuga	2013	②④
Mondeo Turnier 	2007	②④
Ranger	2011	②④
S-Max(Facelift 2010)	2006	②③④
Tourneo Connect	2002 2013	②④
Transit Custom	2012	②③⑥
HYUNDAI *		
Accent  3+5	2000 2005	②④
Coupe	1999 2002	②④
Elantra  5	2000 2006	②④
Getz	2002 2009	②④
H 1 	2007	②④
i 10	2008	②④
i 20	2008	②④
ix20	2010	②④

i 30  	2007 2012	②④
i 35	2009	②④
i 40	2011	②④
Matrix	2001 2010	②④
KIA *		
Carens	2006 2013	②④
Carnival	2005	②④⑤⑦
Ceed  	2006 2012	②④
Ceed  	2012	②④
Cerato	2004 2008	②④
Opirus	2003 2010	②④
Magentis	2001 2005	②④
Picanto	2004 2011	②④
Rio	2005 2011	②④
Rio	2011	②④
Soul	2008	②④
LEXUS *		
GS	1997 2005	 ②④
IS	1998 2005	 ②④
IS	2005 2013	 ②④
RX	2003 2009	②④
MAZDA *		
2 DY	2003 2007	②④
2 DE	2007	②④
2	2013	②④
3 BL	2003 2009	②④

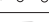
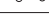
3 BK	2009 2013	②④
5  7	2005 2010	②④
5 CW	2010	②④
6  	2002 2007	 ②④
6  	2008 2012	 ②④
CX 7	2006 2009	②④
CX 7	2009	②④
MX5  5	1998 2005	①
MPV  6+7	1999 2005	
Premacy	1999 2005	②④
RX 8	2003 2012	②④
MERCEDES-BENZ *		
A	05/05	②④
B (Facelift 2008)	06/05	②④
C (Facelift 2004) 	2000 2007	②④
C (W204) 	2007	②④
C (S204) 	2007	②④
C (204)	03/11	②④
E (W212;S212)  	2009	②④
E (C207) 	2009	②④
GLK	2008	②④
ML (W164)	07/05	②④
R (W251/V251)	12/05	②④⑤⑦
SKODA *		
Citigo	2011	 ②④
Fabia I  	1999 2007	②④

Fabia I  	1999 2007	② ④
Fabia II  	2007	② ④
Felicia  	1994 2001	② ④
Octavia I  	2000 2010	① ② ④
Octavia II  	2004 2012	① ② ④
Octavia III  	2013	① ② ④
Octavia Scout 	2007 2012	② ④
Rapid	2012	② ④
Roomster(+Facelift)	2006	② ④
Superb I	2001 2008	② ④
Superb II  	2008	② ④
Yeti	2009	② ④
SUBARU	*	
Forester	2008 2013	② ④
Impreza  	2007 2012	② ④
Legacy  	2003 2009	② ④
Outback	2003 2009	② ④
Outback	2009	② ④
Trezia	2011	② ④
TOYOTA	*	
Auris	2007 2012	② ④
Auris Hybrid	2010	② ④
Avensis(T25)  	2003 2009	② ④
Avensis(T27)  	2009	② ④
Corolla 	1997 2002	② ④
Corolla  	2002 2009	② ④
Corolla  	2006	② ④

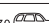
IQ	2009	② ④
Land Cruiser	2002 2009	② ④
Land Cruiser	2009	② ④
Previa/Estima	2000 2006	② ④
Previa/Estima	2006	② ④
Prius	2003 2009	② ④
Prius(+Facelift)	2009	② ④
RAV 4	2000 2006	② ④
RAV 4	2006 2013	② ④
Urban Cruiser	2009	② ④
VOLVO	*	
C 30	2006 2012	 137m ② ④
C 70	2005 2013	② ④
XC 70	2003	② ④
S 40/V 40	1995 2004	② ④
S 40/V 40	2004 2012	② ④
S 60	2000 2009	② ④
S 60	2010	② ④
S 80	1998 2006	② ④
S 80 (+Facelift)	2006	② ④
V 50	2004 2007	② ④
V 50	2007 2012	② ④
V 60	2010	 137m ② ④
V 70 	2000 2007	② ④
V 70  / XC70 (+Facelift)	2007	② ④
XC 60	2008	② ④